

# JB-D PLUS

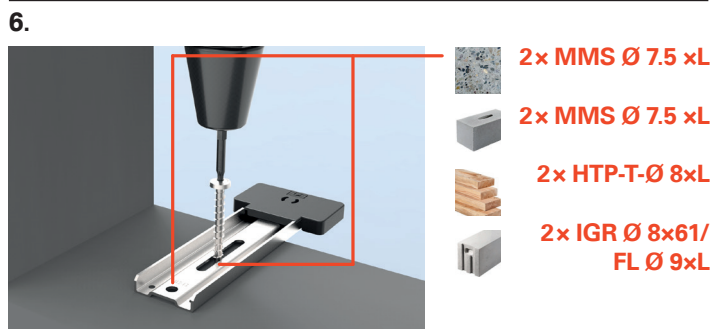

7.

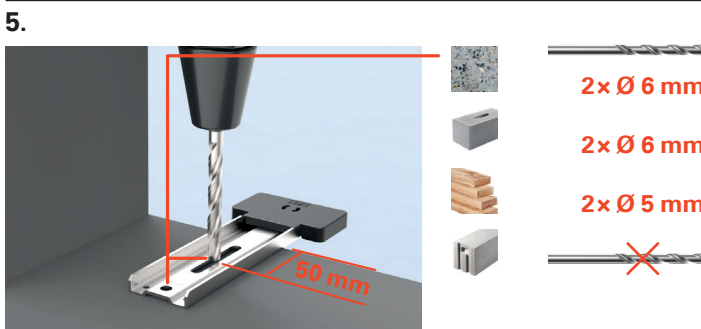
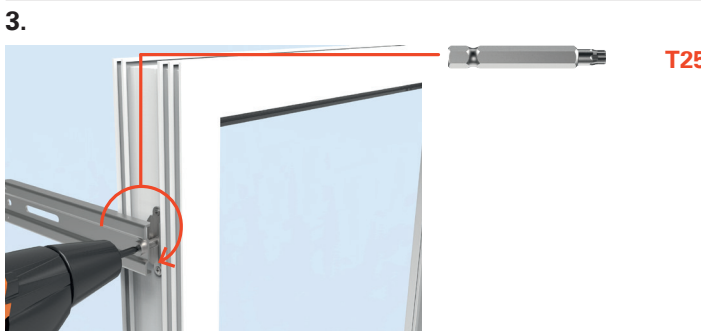
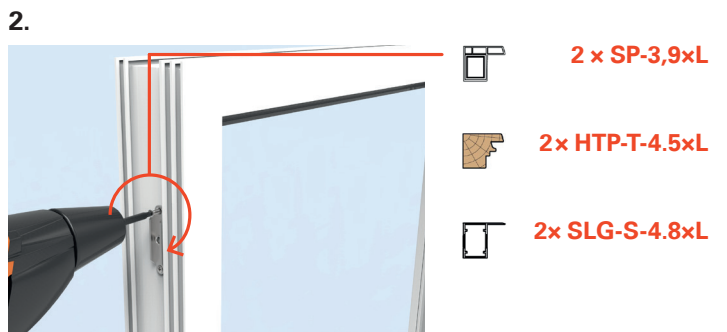
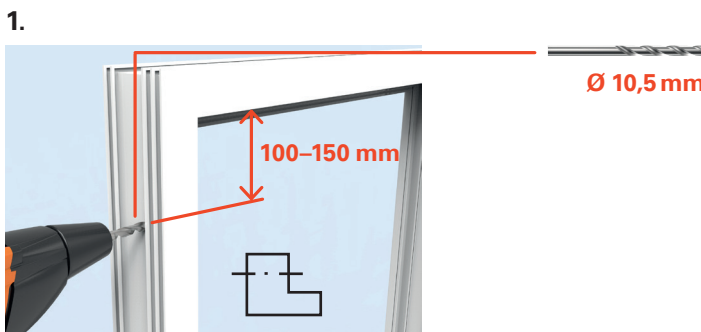
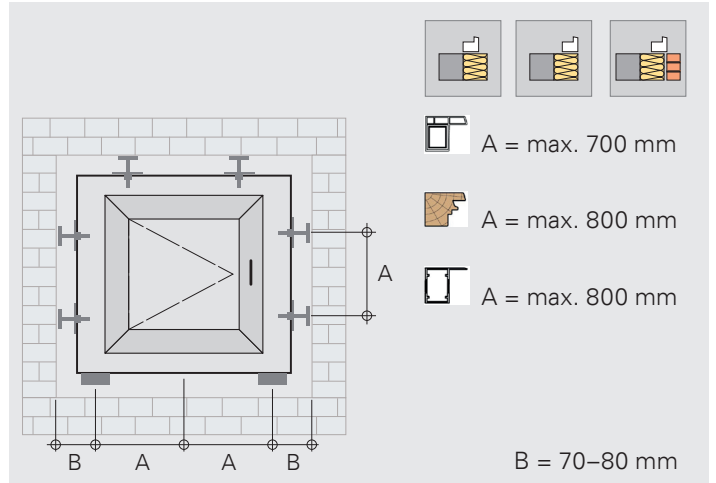
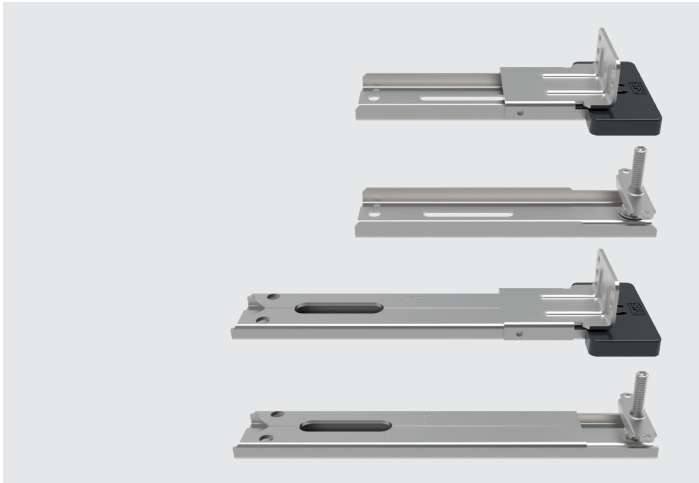
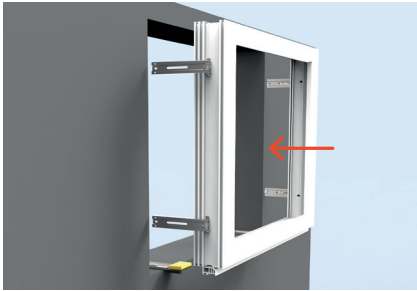

8.

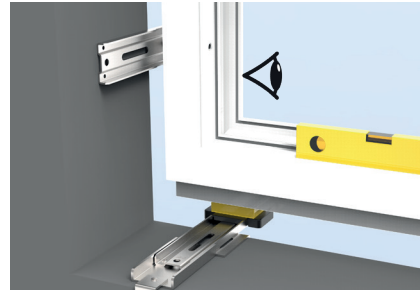

9.

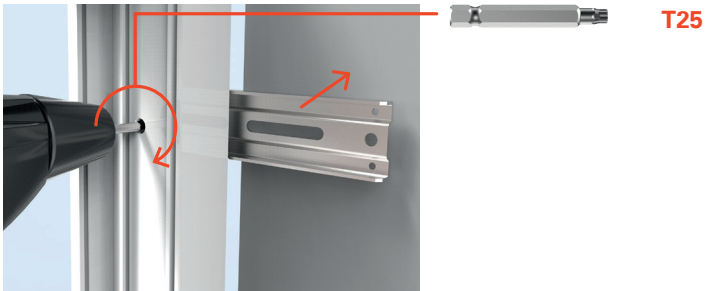

10.

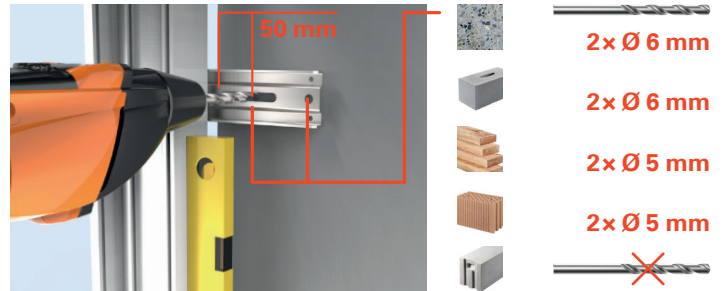

11.

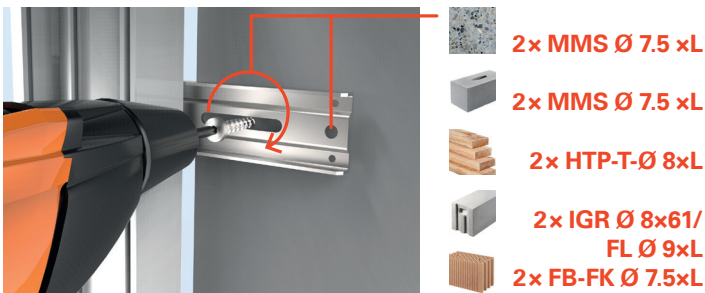

12.

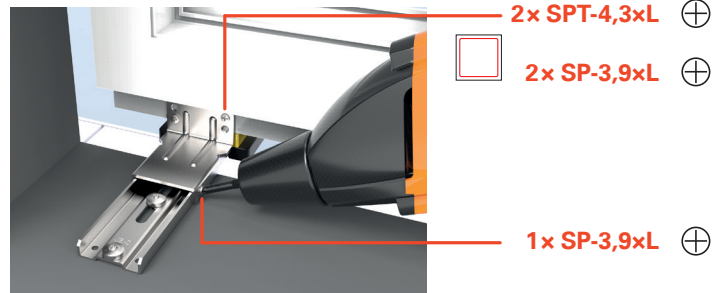

### Rand- und Achsabstände der Befestigung

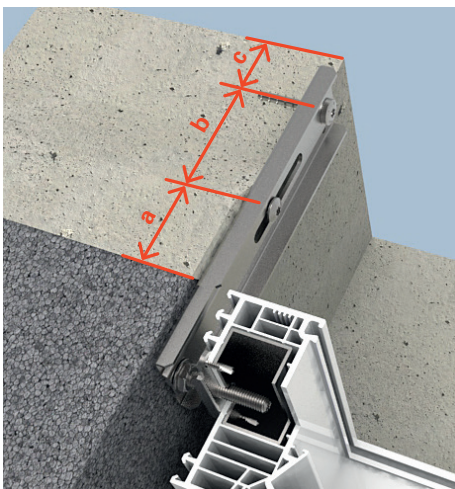

Mauertyp	a mm	b mm	c mm		
	50	≥ 35	≥ 40	Ø 7,5x60	Ø 6 mm, Schlagbohren
			≥ 50		
			≥ 60	Ø 8x80	Ø 5 mm, Drehbohren
			≥ 50	Ø 7,5x132	
				Ø 8x61 Ø 9x245	Ohne Vorbohren